

### Roller Supports, Type RDU without guide

<b>Material:</b>	Roller: <b>S235</b> ; pin: <b>1.4571</b> ; sheeks: <b>S235JR</b>
	Bearing bush: composite bearing made of sintered bronze / PTFE for dry running in difficult conditions
<b>Finish:</b>	Steel parts hot-dip galvanized

Article no.	support load $F_z$ [kN]	L [mm]	A [mm]	H [mm]	B [mm]	C [mm]	beam clamps		weight [kg]
							Typ		
RDU-240/25-F	25	240	305	80	70	75	M12		8,4
RDU-320/25-F	25	320	385	80	70	75	M12		10,0
RDU-240/50-F	50	240	305	100	100	95	M16		16,7
RDU-320/50-F	50	320	385	100	100	95	M16		20,0

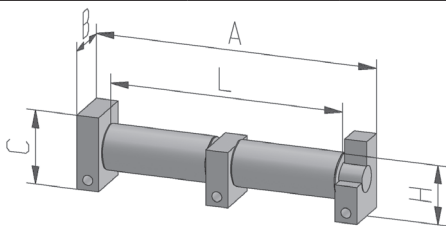

### Roller Supports, Type RDF with guide

Article no.	support load $F_z$ [kN]	L [mm]	A [mm]	H [mm]	B [mm]	C [mm]	beam clamps		weight [kg]
							Typ		
RDF-240/25-F	25	240	305	80	70	100	M12		9,2
RDF-320/25-F	25	320	385	80	70	100	M12		10,8
RDF-240/50-F	50	240	305	100	100	125	M16		17,2
RDF-320/50-F	50	320	385	100	100	125	M16		21,4

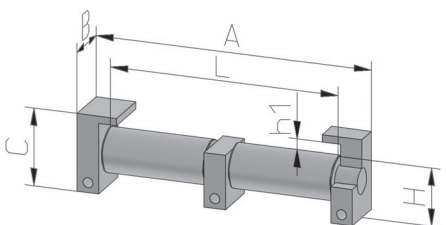

### Roller Supports, Type RDA with lift-off prevention

Restraint against lift-off = 20% of  $F_z$

Article no.	support load $F_z$ [kN]	L [mm]	A [mm]	H [mm]	$h_1$ [mm]	B [mm]	C [mm]	beam clamps		weight [kg]
								Typ		
RDA-240/25-F	25	240	305	80	17	70	107	M12		9,5
RDA-320/25-F	25	320	385	80	17	70	107	M12		11,1
RDA-240/50-F	50	240	305	100	17	100	132	M16		17,6
RDA-320/50-F	50	320	385	100	17	100	132	M16		21,8