

Roller Supports, Type RDU without guide

Material:	Roller: S235 ; pin: 1.4571 ; sheeks: S235JR
	Bearing bush: composite bearing made of sintered bronze / PTFE for dry running in difficult conditions
Finish:	Steel parts hot-dip galvanized

Article no.	support load F_z [kN]	L [mm]	A [mm]	H [mm]	B [mm]	C [mm]		beam clamps Typ	weight [kg]
RDU-240/25-F	25	240	305	80	70	75		M12	8,4
RDU-320/25-F	25	320	385	80	70	75		M12	10,0
RDU-240/50-F	50	240	305	100	100	95		M16	16,7
RDU-320/50-F	50	320	385	100	100	95		M16	20,0

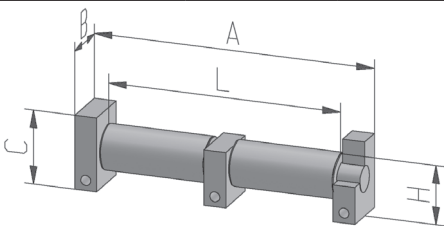

Roller Supports, Type RDF with guide

Article no.	support load F_z [kN]	L [mm]	A [mm]	H [mm]	B [mm]	C [mm]		beam clamps Typ	weight [kg]
RDF-240/25-F	25	240	305	80	70	100		M12	9,2
RDF-320/25-F	25	320	385	80	70	100		M12	10,8
RDF-240/50-F	50	240	305	100	100	125		M16	17,2
RDF-320/50-F	50	320	385	100	100	125		M16	21,4

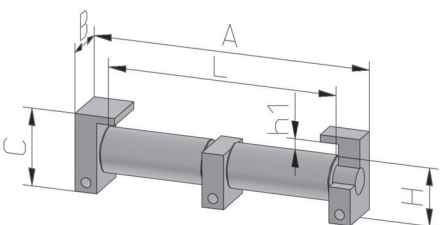

Roller Supports, Type RDA with lift-off prevention

Restraint against lift-off = 20% of F_z

Article no.	support load F_z [kN]	L [mm]	A [mm]	H [mm]	h_1 [mm]	B [mm]	C [mm]	beam clamps Typ	weight [kg]
RDA-240/25-F	25	240	305	80	17	70	107	M12	9,5
RDA-320/25-F	25	320	385	80	17	70	107	M12	11,1
RDA-240/50-F	50	240	305	100	17	100	132	M16	17,6
RDA-320/50-F	50	320	385	100	17	100	132	M16	21,8