

Beam Hangers Type PAH Standard range

Material:	S235JR DIN EN 10025-2, for temperatures up to 300°C
Finish:	hot-dip galvanized, complete with clamp plate and hot-dip galvanized bolt, required preload on clamping plate: M16 - 80 Nm

Article no.	beam dimensions		threaded lug D2	L	C	loads [kN]	weight [kg]
	width A	thikness B					
PAH-120/12-R-F	100 - 120	8 - 11	M12	65	215	4,7	3,50
PAH-120/16-R-F	100 - 120	8 - 11	M16	65	215	8,8	3,45
PAH-120/20-R-F	100 - 120	8 - 11	M20	65	215	13,8	3,40
PAH-160/12-R-F	130 - 160	8 - 13	M12	65	250	4,7	4,10
PAH-160/16-R-F	130 - 160	8 - 13	M16	65	250	8,8	4,05
PAH-160/20-R-F	130 - 160	8 - 13	M20	65	250	13,8	4,00
PAH-200/12-R-F	170 - 200	10 - 16	M12	65	290	4,7	4,40
PAH-200/16-R-F	170 - 200	10 - 16	M16	65	290	8,8	4,35
PAH-200/20-R-F	170 - 200	10 - 16	M20	65	290	13,8	4,30
PAH-240/12-R-F	210 - 240	11 - 19	M12	65	340	4,7	5,20
PAH-240/16-R-F	210 - 240	11 - 19	M16	65	340	8,8	5,15
PAH-240/20-R-F	210 - 240	11 - 19	M20	65	340	13,8	5,10
PAH-300/12-R-F	260 - 300	12 - 19	M12	65	400	4,7	5,85
PAH-300/16-R-F	260 - 300	12 - 19	M16	65	400	8,8	5,80
PAH-300/20-R-F	260 - 300	12 - 19	M20	65	400	13,8	5,75

Other sizes available on request as a special type!

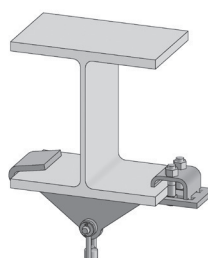
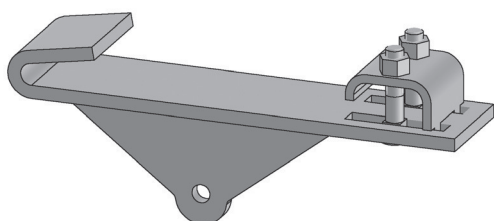

Ordering example: PAH-240/16-R-F	
	Hot-dip galvanized
	Material: S235JR
	M16 lug thread with a load of 8,8 kN
	Clamping range 210 - 240 mm
	Beam hanger Type PAH Standard range